



ROTA AIRLESS\*

**NEW**

# PFT SWING airless

More quiet. More robust. More economical.

\*Airless technology with screw pumps

# PFT SWING airless

The high-pressure pump with  
RotaAirless\* technology

**ROTA**AIRLESS\*

\*Airless technology with screw pumps

## RotaAirless\* spraying without restrictions

The new PFT SWING airless brings almost all pasty materials easily on walls and ceilings. From home interior painting to professional large construction site are projects completed faster and more power efficient.

- ▶ Less noise emission
- ▶ Improved spray quality due to an additional kneading effect in the pump – mixing is quite often not necessary
- ▶ Higher load factor – more applications
- ▶ Low operating costs
- ▶ Easy handling at construction site
- ▶ No service necessary for wear parts

## Easier transport

- ▶ Stable tubular frame
- ▶ Large back wheels
- ▶ Transport is possible in any estate car



## Materials:

- Pasty priming material

## Possible fields of application:

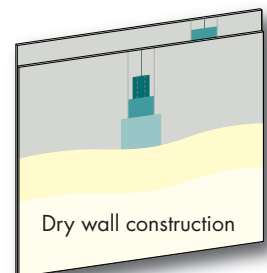

- Spray plaster
- Joint filler
- Colour<sup>1</sup>



- Spray plaster
- Joint filler
- Colour<sup>1</sup>

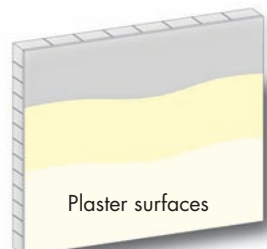

- Plaster, premixed (conversion kit for plaster necessary)

<sup>1</sup> Additional accessories necessary.  
Due to the pump technology it is not suitable for all colours.



#### Controls

- ✓ Clear arrangement
- ✓ Language-neutral
- ✓ Pressure control regulates the operating pressure and machine start/stop



#### Protective grid, low-lying

- ✓ Covered with material in the process and thus easy to clean



#### Wheels, puncture proof

- ✓ No flat wheels, always with the same driving comfort



#### Hub pump shaft – rotor fuse

- ✓ No wear on the pressure flange
- ✓ No shavings in the spray-sensitive area (hose and gun)



#### Bayonet lock

- ✓ Quick dismantling of the rotor-stator packet
- ✓ Easy connection of C-pumps for grainy material

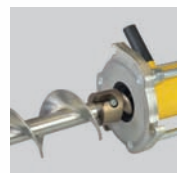

#### Primarily high-quality<sup>2</sup> material in the material flow

- ✓ No discolouration of the material due to rust
- ✓ Weight reduction

<sup>2</sup> Rotor made of hardened alloyed tool steel





### Material hopper, one-piece

- ✓ PE hopper reduces material adhesion
- ✓ No back taper and thus improved material flow
- ✓ Easy cleaning
- ✓ Weight reduction



### Cover material hopper

- ✓ Protection from impurities



### Tool box

- ✓ Necessary tool always available



### Transport handles, pluggable

- ✓ Easy cleaning and maintenance



### Bypass filter

- ✓ Easy cleaning and maintenance





### **Surface expertise**

Looking surfaces fascinate people since there are walls and ceilings. Today, however, the possibilities of finishing of walls are enormous. Modern processing technology enables impressive surfaces. Plastering, smoothing, refining – with the PFT SWING airless you are on the right way.



MADE IN GERMANY

All rights reserved. Subject to change without prior notice. Our warranty refers only to the perfect condition of our machines. Consumption, quantity, design specifications and performance data are empirical values, which cannot be transferred automatically in case of deviating conditions. In addition, the guidelines of the material manufacturer are always applicable. Changes, reprints and photomechanical reproductions, even in parts, require the approval of Knauf PFT GmbH & Co. KG.

PFT SWING airless – GB/1M/01.15/PFT



## Knauf PFT

Technical Hotline:

► +49 9323 31-1818

► Phone +49 9323 31-760

► Fax +49 9323 31-770

► info@pft-iphofen.de

► www.pft.eu

Customer-friendliness, technical expertise and service-orientation. That's what the PFT brand with its sales and service centers worldwide stands for also in the coming decades.

## Technical data

## PFT SWING airless

## Extended delivery contents

<b>Description</b>	<b>SWING L FC-230 V airless</b>
<b>Part no.</b>	<b>00 45 13 36</b>
<b>Connection value</b>	230 V, 1 Ph, 50 Hz, 3 kW
<b>Drive</b>	3 kW, 0–280 rpm
<b>PE Material hopper</b>	plastic
<b>Outflow with mortar pressure gauge</b>	sensor with digital display
<b>Wheels</b>	4 wheels
<b>Handling and control</b>	pump capacity is continuously adjustable via potentiometer, adjustable working pressure range

### Dimensions

Filling height	700 mm
Hopper content**	70 Liter ~ 2.3 bags
Length/width/height	1,430/500/720 mm
Total weight	100 kg

### Performance data

Conveying capacity*	0–6.5 l/min
Pump unit*	306 airless · 6.5 l/min · 130 bar
Conveying distance*	20 m at DN12

\* Depending on material quality, material composition, material consistency, pump type and condition, diameter of conveying hose and conveying height.

The directives recommendations of the material producer are to be observed.

\*\* bags with a content of 30 kg

- RONDO DN12 – 20 m
- Spaying gun In line Textspray – nozzle 541
- Connection cable 3 x 1.5 mm<sup>2</sup>, BLU 2-16 A – 5 m
- Bag squeezer SWING airless

*Please note: only included in the delivery contents in the version with bag squeezer*

### SWING L FC-230 V airless with bag squeezer

Part no. 00 45 13 35



Please find further information and accessories under **www.pft.eu**

**Click. Discover. Experience.**  
**360°** [www.pft.eu/360\\_SWING](http://www.pft.eu/360_SWING)

Knauf PFT GmbH & Co. KG  
P.O. Box 60  
97343 Iphofen  
Einersheimer Straße 53  
97346 Iphofen  
Germany

Knauf AMF  
Ceiling Systems

Knauf Bauprodukte  
Pro Solutions at Home

Knauf Dämmstoffe  
Polystyrol Insulating Material

Knauf Gips  
Dry construction Systems  
Soil Systems  
Plaster and Facade Systems

Knauf Insulation  
Insulating Material for  
Renovation and New Build

Knauf Integral  
Gypsum Fibre Technology  
for Soil, Wall and Ceiling

Knauf AQUAPANEL  
AQUAPANEL® Cement Board  
TecTem®, Insulating Material Fill

Knauf PFT  
Machine technique, Plant Manufacturing

Knauf riessler  
Surface Expertise

Marbos  
Mortar Systems for  
Paving Cover in Civil Engineering

Sakret Bausysteme  
Dry Mortar for  
New Build and Renovation